

- PMMA opal matte cover
- PMMA semi-clear cover
- PMMA clear cover
- PC diffused cover

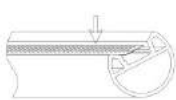

End caps



**Step 01:**  
Stick led strip

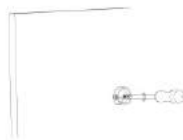

**Step 03:**  
Lock the end caps  
inside the cabinet

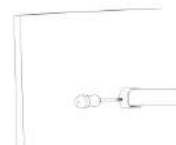

**Step 05:**  
Fix the Aluminium profile

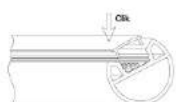

**Step 02:**  
Push the diffuser inside



**Step 04:**  
Slide the cover plates



**Step 06:**  
Installation completed